



PRESS PACK

Le Grand PaRI(S)

**EXHIBITION OF THE RESULTS
OF THE INTERNATIONAL
CONSULTATION ON THE FUTURE
OF THE PARIS METROPOLIS**

**RICHARD ROGERS / YVES LION / DJAMEL KLOUCHE
CHRISTIAN DE PORTZAMPARC / ANTOINE GRUMBACH
JEAN NOUVEL / BERNARDO SECCHI E PAOLA VIGANÒ
FINN GEIPEL+GIULIA ANDI/ROLAND CASTRO/WINY MAAS**

3RD APRIL - 22ND NOVEMBER 09

Le Grand PaRI(s)

EXHIBITION OF THE RESULTS OF THE INTERNATIONAL
CONSULTATION ON THE FUTURE OF THE PARIS METROPOLIS

FROM 3RD APRIL TO 22ND NOVEMBER 2009

Cité de l'architecture & du patrimoine
Palais de Chaillot – 1 place du Trocadéro – 75116 Paris
Open to the general public

CONTACTS PRESSE

Cité

Agostina Pinon
Tél. 01 58 51 52 85
06 03 59 55 26
apinon@citechailot.fr

Opus 64

Valérie Samuel & Arnaud Pain
Tél. 01 40 26 77 94
a.pain@opus64.com

WWW.CITECHAILLOT.FR
WWW.LEGRANDPARIS.CULTURE.GOUV.FR



Val de Seine Aménagement



PREFACE BY THE PRESIDENT OF THE REPUBLIC OF FRANCE

We need to rethink the city. To look further and deeper. To do everything possible to make our cities better to live in, more attractive, more sustainable, more human. That is the spirit of the consultation that I wished to launch by calling on ten great architects and urban designers, some of the finest of our age.

It was time to begin a major effort of reflection, time to revitalise our thinking about the cities, so that our modern landscapes should no longer be a simple residue of human activity, but the considered product of policies agreed by all, responsive to all.

This large-scale wager on the future has nothing to do with a traditional design competition. It is a concerted effort to understand how cities are produced, so that we can understand how to make them better. An effort that means exploring the urban question from every perspective – geographical, social, environmental, economic, poetic and even philosophical: in the age of the Internet and high-speed travel, through which human beings can stride not just across cities, but even entire countries, what does it mean to “inhabit the city”, to “be metropolitan”?

The situation is urgent. The “sustainable development” imperative is no more than the political expression of the need to save our planet from imminent destruction. At a time when half of humanity has moved into the cities, it is in the cities that action is required.

Now is not the time for “laissez-faire” nor for the blank slate. We need to “make do”, form, reform, transform, remodel – industrial wastelands and inner-city estates alike.

It was my wish that architects should be the pioneers of this research, of this global action on the “post-Kyoto” city, and I wanted them to have complete freedom, in the choice of their teams, of their subjects and of their proposals.

Ten truly profound studies have been produced in record time, through an intense effort by experts and researchers from all disciplines across the world, driven by infectious enthusiasm and convinced of the urgent need for action.

The diametric opposite of utopianism, profoundly rooted in the reality of the metropolitan soil, these ten scenarios on the city show us what paths we need to follow to re-establish links, iron out inequalities, amplify dynamics, and to rediscover the communion of the city and of nature by exploiting strengths of which we are no longer even aware. They bring us the proof, if that were necessary, that Paris is a city that extends well beyond the Péripherique, a great global metropolis.

And above all, they give us a lesson in wisdom and humility: whether the city of the future is compact or diffuse, dense or porous, it must above all be open and flexible. We need to treat the city not as a technical space, a collection of “zones” to be manipulated, but as an organic system, a fabric that must remain sufficiently malleable to adapt to our needs and to match our dreams. If we do this, we can face any challenge, even those as yet beyond our knowledge...

It is up to all of us, politicians, citizens, professionals, to take up this magnificent challenge.



Nicolas SARKOZY

THE CITY, A DEEPLY CULTURAL ACT

THREE QUESTIONS FOR CHRISTINE ALBANEL, MINISTER OF CULTURE AND COMMUNICATION

As Minister of Culture and Communication, the President of the Republic has put you in charge of conducting this international research and development consultation on Greater Paris. Does this mean that the debate on the future of large metropolises is also, and perhaps above all, a cultural question?

Yes, I am deeply convinced of it. The urban condition, which has become the principal condition of our planet, the major issue of this beginning of the century, questions first off our ways of living together in a society. When you work on the city, you do not bring together only walls or spaces, networks or flows, you also bring together people, cultures, identities, aspirations. It is this complexity of living together, which is in no way automatic, that makes the city a deeply cultural act, I would even say civilization's challenge of building and thinking in common. From this viewpoint, architecture, capable of giving the city to people, capable of reinventing our daily life, both individual and collective, embodies the vitality of a society and its culture.

I was very touched by the fact that the President of the Republic himself conceived this consultation as a cultural project. I very quickly measured its challenges, but also the very great responsibility that was incumbent on me. And I am truly very happy that the process has finally led to a result whose quality is also unanimously praised today.

What were you expecting from this consultation, whose proposed scheme seemed innovative for more than one reason, starting with the meeting of professionals in the use of space, architects and urban planners, and multidisciplinary teams that included sociologists, geographers, economics, artists and others?

First off, I would like to point out that the Ministry of Culture and Communication was not the only one involved in this adventure. To successfully carry out this unprecedented consultation, we formed partnerships with the city of Paris, the Île-de-France region and the Association of Mayors of Île-de-France who worked alongside us, and I would very much like to sincerely and warmly thank them. Their deep involvement, especially on the steering committee, laid the foundations for a large-scale democratic exercise on the conditions required to produce the contemporary city.

As for my expectations, although I never had any preconceived ideas of what the metropolis of the future was to be, I believed, on the other hand, in the quality of the scheme we had established, in both the plan of its formal organisation and its methodology: a steering committee bringing together the major political stakeholders concerned by these challenges, a scientific council to provide a sounding board and to initiate a critical discourse on the production, the systematic union in each team of several disciplines headed by urban planners and architects, etc.

As each scientific coordination seminar (three in all), which provided access to the team's partial results, was held, I really saw new concepts of, new approaches to urban, green space and architectural development spring up before my eyes. The revamped relationship between the city and nature, in particular, at the heart of the proposals of the great majority of the teams, seems crucial to me for the future of our cities. I would also like to mention the remarkable work accomplished to propose new representations of the urban space, which are, in my opinion, as decisive as the invention of a language tailored, for example, to new philosophical concepts. Anything that is well designed is clearly worded, isn't it...? I felt a maturity in the approaches and an investment on the part of these teams that went well beyond the commission, which was however dense, that was given to them.

How do you imagine the follow-up to the consultation?

The research and prospective phase ended on March 12 with the final scientific coordination seminar. We have now entered a restitution phase which I would like to be as rich as possible, in the form of debates, exhibitions, meetings, etc. and which will have the generic title: "Rendez-vous du Grand Paris". It began on March 17 at the Théâtre national de Chaillot with a large-scale public debate organised by the Cité de l'architecture & du patrimoine.

It will be continued, I am sure, with the exhibition organised by the Cité de l'architecture, whose challenge is above all to permit all the residents of the Île-de-France, and those further afield to take ownership of their metropolitan future, to think about it, to discuss it.

And it will continue throughout 2009 with the organisation, in the regions, by national architecture schools, in liaison with the local governments interested, especially Bordeaux and Nantes, of debates and research on the regional metropolises and the large regions of the 21st century. The other major public debate, which will be held at the Centre Georges Pompidou, must be mentioned, as well as the series of international collaborations which will begin in Rio, Brasilia and Buenos Aires. As we can see, we are entering a very important phase that must really make it possible for all the teams' diagnoses and proposals to, in a certain way, go down into the street. It is an indispensable path for anyone who wants to lead and expand this great democratic exercise that I have talked about.

I would like to add that I was pleasantly surprised and very impressed by the proof of the consensus that was imposed on all ten teams through their diagnosis and the large majority of their proposals. This prospective diagnosis is tremendous material for undertaking, without any delay, the creation of the metropolitan territory of tomorrow. It is now up to the decision-makers to make good use of it over the next thirty years!

THE CITY TO THE POWER OF 10

Initiated by the President of the Republic at the opening of Cité de l'architecture & du patrimoine on September 17, 2007, the "international consultation for the future of metropolitan Paris" was the starting point for an extraordinary process of reflection on the city. Nine months of reflection, ten entirely new scenarios.

The ten multidisciplinary teams, headed by architects and urban planners, have each explored a new kind of urban planning, which excludes any notion of creating cities from scratch. The days of untrammelled development – such as the new towns that emerged in the post-war years – are over. Today, it is time to remodel our capital region.

Given two remits to work on – "the 21st-century post-Kyoto metropolis" and "diagnostic forecast for the Paris conurbation" – the teams explored the widest possible range of options, in the awareness that ecology and economy, mobility and social cohesion, are intimately connected.

This "research and development" approach was a way to link theory and practice, future and present. The consultation produced an intense and diversified harvest, the envy of our neighbours abroad.

Doing justice to such a rich and fundamentally complex collection of outcomes was a challenge, which Cité de l'architecture & du patrimoine met by offering its finest exhibition space: the Carlu Gallery, within the Museum. At the heart of this unique collection, the ideas on the contemporary metropolis are magnificently at home. The work of the museum's scenery designer, Jean-Christophe Quinton, resembles an installation in a moulded landscape. The "modular village" occupied by each team, where he has contrived to develop his own "method of representation" of the metropolis, will make the projected ideas and hypotheses easy to see and understand. The result is apparent: ten widely differing projects, since despite certain convergences there remains a great diversity of approaches and strategies. In this adventure, history meets geography, and urban planning is treated not functionally, but globally. For the public and politicians alike, a wide field of possibilities unfolds.

François de Mazières
Chairman of the Cité de l'architecture & du patrimoine

Francis Rambert
Director of the French Institute of Architecture

FROM CITY AS CENTRE TO METROPOLITAN AREA

Whilst inner Paris, with its 2 million inhabitants, covers an area of 105 km², Paris as a conurbation extends over more than 2500 km² and is home to some 10 million people ... The question of how to define and organise this "Greater Paris" exercised the minds of politicians, urban planners and architects throughout the 20th century.

"Le Grand Pari de l'agglomération parisienne" [the great Paris conurbation wager] is an international competition launched by the Ministry of Culture and Communication. It is addressed to multidisciplinary teams assembled by architects and urban planners for the purpose of redefining the structure of the metropolitan area and proposing possible strategies. The objective is to broaden a debate that currently takes place at regional level (Île-de-France master plan or SdrIF) and, against a background of international competition between cities, to speed up the search for solutions to the problems of the city of Paris, by exploring beyond existing urban planning methods and models.

OBJECTIVE, ISSUES AND CHALLENGES

When Cité de l'architecture & du patrimoine opened in September 2007, the President of the Republic expressed the wish for a "new project for the global development of greater Paris" to be explored through an international consultation process.

On June 4, 2008, ten teams were selected by a panel of central government and local government representatives. They then had nine months, punctuated by meetings with the many actors involved in the development of the region, to mature their ideas. The teams presented their final proposals on March 12 to the competition's scientific council and steering committee, and five days later at a public hearing.

More than just a competition of ideas, "Le Grand Pari de l'agglomération parisienne" is a research and development project, whose outcomes will serve to clarify the process of political decision-making. The ten teams have helped to construct a "territorial approach" to the analysis of the future of the 21st-century metropolis in general, and of the Paris conurbation in particular.

The competition is divided into two parts. The first part resembles a piece of basic research focusing on "the 21st-century post-Kyoto metropolis". The second part takes the form of applied research on "a diagnostic forecast for the Paris conurbation".

These two research subjects raise the question of how users and institutions take ownership of space in the contemporary city. Both are intended to generate the understanding required for the emergence of a territorial strategy. Both of them seek to develop tools for the long-term development of the metropolitan area. And finally, both will need to provide arguments that can underpin the negotiation, the consultation and the decision-making that constitute urban governance.

PROGRAMME

"The 21st-century post-Kyoto metropolis"

Under the Kyoto protocol, the signatory countries have precise targets for cutting greenhouse gas emissions by 2012, in the hope of slowing down global warming... By aligning itself with the protocol, this element of the competition stresses the importance of sustainability for the Paris metropolis, a guiding thread in all the research projects.

The teams looked at the questions of governance, urban forms and flows, collective representation, etc., which apply in a metropolis that is undergoing rapid and often unmanaged change. Their ideas matured in particular through comparisons between Paris and other major international cities (New York, Tokyo, São Paulo, Mexico City, etc.). They identified the environmental, economic, societal and cultural challenges facing cities in this new century.

The representations that spring from this research are replete with innovation and poetry that provide glimpses of what this space might become.

“Diagnostic forecast for the Paris conurbation”

The second piece of research is also conceived as a second phase. On the basis of the previous theoretical investigations, the teams were asked to draw up projects for the Paris metropolis. Their diagnostic forecast highlights two major challenges.

Firstly, it raises a geographical question. How big should “Greater Paris” be? The teams were able to translate this first question into proposals designed to create a genuine urbano-regional identity. Depending on each team’s sensibilities, taking ownership of urban territory begins with the remodelling of transport services, with flagship projects to create new urban centres, with the construction of new public amenities...

Moreover, their analysis reiterates the singularity of the Paris region. The city’s distinctive qualities and features are highlighted and confirmed as assets in the international rivalry between capitals.

Frédéric Mialet

ÉQUIPE 1

ROGERS STIRK HARBOUR AND PARTNERS

LONDON SCHOOL OF ECONOMICS / ARUP

THE COMPACT, CONNECTED CITY

“I don’t know of any big city in which the heart is so separate from the limbs”, says Richard Rogers of the Paris metropolis. The Greater Paris sketched here is an exemplary city, with a small ecological footprint, which guarantees accessibility, employment, housing, mobility, beauty, ... for all.

A city in which the heart no longer sucks in all the resources, but shares them. Its skeleton is made up of large-scale armatures: its axial routes follow the underused footprint of the existing railway lines, impenetrable scars at the heart of the cities, which are reoccupied and transformed into genuine infrastructures. Below ground, the entrails of the water conveyance and sewage networks, sustainable version; on the surface, a skin of green corridors, leisure parks, green travel routes, with a light traffic of electric cars... From Gare du Nord, Saint-Denis 7 km away can be reached without stepping out of a 65 ha park containing amenities and housing. Along routes like this, property values are restored. These new armatures cross the Périphérique via landscaped or inhabited bridges. They link Paris to urban centres in the inner ring, densified nodes with mixed, reversible housing and economic development zones connected by a new belt of public transport services. Further out, a greenbelt zone limits the expansion of the city while protecting its natural reserves.



© ÉQUIPE ROGERS STIRK HARBOUR & PARTNERS

ROGERS STIRK HARBOUR AND PARTNERS

Richard Rogers / Mike Davies / Lennart Grut / Stephen Barrett

Maria Hadjinicolaou / Henry Fletcher

soutenus par : Philip Dennis / Mike Fairbrass / Vidal Fernandez Diez / Martha Gale

Michael Hughes / Jon Mercer / Alison Oktay

LONDON SCHOOL OF ECONOMICS

Urban Age, une investigation internationale sur le futur des villes organisées par la London School of Economics et par la Alfred Herrhausen Society de la Deutsche Bank
Ricky Burdett / Philipp Rode / Christos Konstantinou / Antoine Paccoud / Kay Kitazawa
Richard Simpson

soutenus par : Omer Cavusoglu / Adam Kaasa

ARUP

Dr Rick Wheal / Dr Steve Finnegan / Alejandro Gutierrez / Darren Briggs

CONTRIBUTEURS

Dr John Barrett, Stockholm Environment Institute / Sophie Body-Gendrot, La Sorbonne, Paris / Tony Travers, London School of Economics / Mark Major, Spiers and Major
Lighting Consultants / Stuart Blower

ÉQUIPE 2

GROUPE DESCARTES

ÉNSA DE LA VILLE & DES TERRITOIRES À MARNE-LA-VALLÉE

ÉCOLE NATIONALE DES PONTS ET CHAUSSÉES,

UNIVERSITÉ DE MARNE-LA-VALLÉE

90 INITIATIVES TO GET THE METROPOLIS MOVING

The geographical reality of the Paris metropolis overwhelms existing systems of governance. The disconnect between the local – neighbourhood, village – and the metropolitan global is resolved here with the creation of twenty cities of 500,000 people, which introduce a connection between these two scales.

Transport services maintain overall cohesion. A smart system of speed adjustment, infrastructure adaptation and transport provision reduces daily commuting time while making it possible for everyone to move around the metropolis in all directions... Here again, there is a shift of scales: motorways become metropolitan boulevards that carry public transport services. The project also incorporates residential mobility. To make it a matter of choice rather than necessity, the Descartes Group does away with the planning rules that freeze land use. There is space everywhere: in urban wastelands, on the roofs of buildings, in gardens... Building goes on in the gaps, existing housing is enlarged, dwellings become more numerous and larger. Anticipating significant levels of global warming, the team proposes a city interwoven with vegetation. The development and cultivation of allotments, parks, gardens and above all woodland, reduces temperatures within the metropolis and form an urban landscape that offers nature a new home.



© ATELIER LION - GROUPE DESCARTES

ARCHITECTES URBANISTES

Ateliers Lion architectes urbanistes

Yves Lion, architecte urbaniste, mandataire commun

A. Bertrand, D. Jolly, J. Lafille, C. Pigué, J. Stéfaneli

François Leclercq, architecte urbaniste

P. Bailly, D. Baldé, Ch. Daubas, R. Ferrand, G. Saffray

Seura architectes

David Mangin, architecte urbaniste

E. Roncen, V. Chazelle

T.V.K. architectes urbanistes

Pierre-Alain Trévelo, Antoine Viger-Kholer, architectes urbanistes

A. Auvray, S. Bayce, A. Bullier, H.-W. Jung

ELEX

Eric Lapierre, architecte

M. Bergeret, K. Busby

Marc Mimram, architecte ingénieur

A. Turchetti

Atelier Alfred Peter

Alfred Peter, paysagiste

J. Buyck, F. Almi, R. Fischkandl

RECHERCHE

**Laboratoire Techniques territoires et sociétés
(LATTS) École nationale des ponts et chaussées
Université de Marne-la-Vallée - CNRS**

Jean-Marc Offner, ingénieur, politologue, directeur du LATTS

Olivier Coutard, ingénieur-économiste, directeur de recherche au CNRS

Ludovic Halbert, géographe, chargé de recherche au CNRS

Christian Lefèvre, politologue, professeur à l'Institut français d'urbanisme

**Centre d'enseignement et de recherche Eau ville environnement (Cereve) /
École nationale des ponts et chaussées**

Bruno Tassin, ingénieur, chercheur au Cereve

Observatoire de la condition suburbaine (OCS),

École nationale supérieure d'architecture de la ville & des territoires à Marne-la-Vallée

Soline Nivet architecte, docteur en architecture, chercheur associé à l'OCS

PERSONNALITES CONSULTÉES

Praticiens et chercheurs

Campana & Eleb, communication / Jean-Charles Eleb et André Campana

Jean-Louis Cohen, architecte historien

CVL Ingénierie commerciale

Sophie Simonet

Détente consultant, ingénierie touristique, culturelle et de loisirs

Joseph Tomatis

Patrick Faigenbaum, artiste

Mathieu Flonneau, historien (Paris I)

Elisabeth Gouvernal, économiste des transports INRETS

Hervé Jobbé Duval, assembleur de projets

Joachim Lepastier, vidéo

Jacques Lucan, architecte

Météo France/CNRM-GAME et GMME/TURBAU Toulouse

Eric Brun, directeur de recherche

Valéry Masson, Grégoire Pigeon, Aude Lemonsu

Jean-Pierre Orfeuill, ingénieur et chercheur déplacement

Michel Schuppisser, Zurich, déplacement

Transsolar, Stuttgart, optimisation climatique et énergétique,
prise en considération du développement durable

Thomas Auer, Arnaud Billard

Marc Wiel, urbaniste, ingénieur

ILLUSTRATIONS, PERSPECTIVES

Catherine Simonet

Pierre du Plan

GRAPHISME

Perrine Rousselet

PHOTOGRAPHIES

Éric Lion

ÉQUIPE 3

L'AUC

GREATER PARIS STIMULATED

FROM URBAN LEGACY TO CONTEMPORARY PARISIAN SITUATIONS

Reversing the normal order of planning, AUC analyses the status quo and refuses to map the territory before defining its projects. From 18 characteristic places in the “inherited” Metropolis, the outlines of a sensory portrait of Greater Paris emerge. Places of residence, of production or of passage such as Villetaneuse, Croix-Blanche, Gif-sur-Yvette, Bobigny or Versailles... can be reproduced, even modelled.

They form the “matrix” out of which emerge seven ways of changing the city by revitalising forgotten territories, by linking traditionally separate fabrics such as the big high-rise estates, sprawling detached housing districts and historic Paris, by generating added value in clusters – research and business areas – that are themselves embedded in areas where people live. Cars are not excluded, but electric vehicles – less polluting, less noisy, less numerous – transform the roads into friendlier and more liveable urban boulevards. This city is careful to avoid establishing new forms, typologies or height limits. However, it promulgates two principles: the stations and transport axes – hubs of interchange and flow – must generate an inhabited, dense and mixed urban thickness, which structures and irrigates the territory. On sites that are distinguished by their history or their geography, “metropolitan accumulators” are constructed to encourage encounter and interaction. The “very very large Louvre” is the first of these, Roissy is another.



L'AUC

Djamel Klouche / François Decoster / Caroline Poulin / Ido Avissar / Robert Helmholtz
Susanne Eliasson / Alice Luraghi / François Chas / Mariee Ishizuka / Adrien Delange
Gaétan Brunet / Flavien Menu / Martin Jaubert / Augustin Caradec

+ OHNO LAB + AVANT

Hidetoshi Ohno / Koji Matsushita / Masafumi Mori / Julien Corbin

+ PASCAL CRIBIER + Patrick Ecoutin

+ LADRHAUS

Laboratoire de recherche histoire architecturale et urbaine - sociétés

Catherine Bruant / Emmanuel Bellanger (CNRS, Centre d'histoire sociale du 20^e siècle, université Paris I, associé) / Catherine Blain / Jacques Sauterau

+ CITEC Philippe Gasser

+ H5

François Alaux / Quentin Brachet / Nicolas Rozier / Alexandrine Leclere

+ MSC Michel Suire

+ ISABELLE THOMAS

ÉQUIPE 4

ATELIER CHRISTIAN DE PORTZAMPARC

INSTITUT D'URBANISME DE PARIS

FROM CYBERSPACE TO THE PHYSICAL WORLD

THE CHALLENGE FOR THE METROPOLIS

The city here is perceived as a quasi-biological system, where metropolitan-scale functional spaces and local physical spaces need to be reconciled with sustainable resource management. Rapid transit routes, which currently divide up the city and create enclaves, offer an opportunity to develop an alternative to the compact city. More open and better structured, the metropolis as envisaged by this team forms rhizomes, like bamboo roots, which follow linear pathways rather than depending on a single trunk.

Singular spaces, linked but possessing relative autonomy, constitute the city's different "organs", which contain what are essentially "metropolitan switch points, capable of connecting the global and the local". The team explores six variants on this system through "project windows", representing locations that are very different but equivalent in size, measuring 5 km x 10 km. In these areas the team remodels the urban fabric and access routes: towers spring up, built-up areas abut wild or cultivated natural spaces. The Annulaire ringway, a new overhead metro, provides a metropolitan link running above the Boulevard Périphérique.

Nord-Europe Station is born in Aubervilliers from the merger of the existing Gare de l'Est and Gare du Nord, and becomes the heart of the region's biggest business district, linked to the historic centre of Paris by a green route.



© ATELIER CHRISTIAN DE PORTZAMPARC

POLE ARCHITECTURE URBANISME

Atelier Christian de Portzamparc

Christian de Portzamparc, architecte urbaniste

Avec : Léa Hua Xu, architecte dplg, chef de projet

et Chantal Aïra-Crouan, Alexis Lorch, Camille Henry, Erwan Saliva, Yannick Bouchet, Etienne Pierres, Thierry Damez, André-Jacque Bodin, Clovis Cunha, Ana Paula Pontes, Abderahim Nouaiti, Jean Charles Chaulet, Benoit Hauvillers, Quyet Tien Ngo, Maxime Vincent, Juan Li, Arnaud Rossocelo, Alexandre Guibourt, Julien Deming, Daisuke Tanaka, Etienne Gobin, Renata Zisman-Bolliger, Célia Hadjouti, Marion Rhein, Amine Ibnolmobarak, Rodrigo Garcia-Sayan

Conduite du projet, coordinateur des équipes et experts

Didier Martin, économiste

POLE RECHERCHE & EXPERTISE SCIENTIFIQUE

**Institut d'urbanisme de Paris au sein de l'université Paris XII Laboratoire CRETEIL
(Centre de recherche sur l'espace, les transports, l'environnement et les institutions locales)**

Équipe de recherche pluridisciplinaire fondée en 1999 à l'Institut d'urbanisme de Paris (IUP), université Paris XII

Daniel Béhar, géographe, chercheur et professeur associé au Creteil (IUP),
coordinateur du réseau Creteil

Laurent Davezies, professeur à l'université Paris-Val de Marne (en poste à l'IUP)
et expert indépendant

Jean-Claude Driant, urbaniste et géographe, directeur du Creteil (IUP)

Jean-François Langumier, expert aménagement du territoire, chef de la mission
Prospective et développement durable, Autoroutes Paris-Rhin-Rhône (APRR)

Patrice Noviant, urbaniste, directeur de recherche au laboratoire ACS de l'École
nationale supérieure d'architecture de Paris-Malaquais

Jean-Pierre Orfeuill, ingénieur et statisticien, en poste à l'IUP, codirecteur du Creteil
et spécialiste des questions de transport

Bruno Queysanne, sociologue et philosophe, professeur émérite d'histoire et de
philosophie à l'École nationale supérieure d'architecture de Grenoble

Vincent Renard, spécialiste d'économie foncière et immobilière, directeur de recherche
au CNRS

Michel Savy, expert des questions logistiques, professeur à l'université Paris XII
et à l'École nationale des ponts et chaussées

Claire Tutenuit, expert développement durable, délégué général de EpE
(Entreprises pour l'environnement)

ÉQUIPE 5

ANTOINE GRUMBACH & ASSOCIÉS

SEINE MÉTROPOLE

Most of the great international cities are ports, generally situated at the mouths of rivers. Globalisation is largely driven by maritime transport. To reduce the handicap of Paris' inland location, this team opens the capital to the sea via Rouen and Le Havre. Its growth becomes linear rather than radial-concentric.

The creation of a metropolis with the Seine as its axis makes use of a remarkable landscape feature, fringed with significant forested slopes. With its industrial know-how and its geography, the valley would facilitate the development of green energy. The farmlands contribute to food self-sufficiency in the villages, where people would move from the city. This project calls for a different conception of mobility, combining river, rail and road. The priority is to "place the capital" one hour from Le Havre with a new TGV line, but also to develop river traffic between the two cities.

At the same time, currently underdeveloped or abandoned sites all along the Seine, in particular Achères, downstream from Paris, would be revitalised. Bringing such an ambitious project to fruition would obviously require civil society to be motivated through short-term initiatives, such as a big international exhibition.

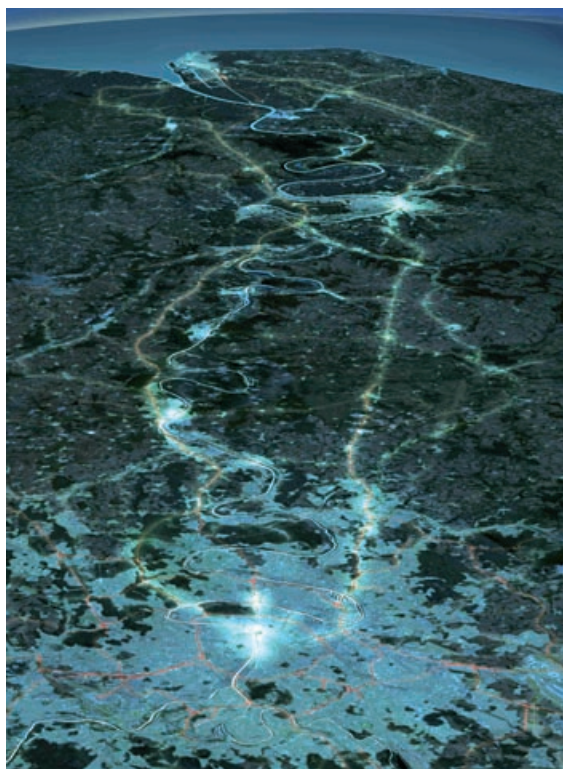

© AGENCE GRUMBACH & ASSOCIÉS

ANTOINE GRUMBACH & ASSOCIÉS, MANDATAIRE

Antoine Grumbach, architecte urbaniste, professeur à l'École nationale supérieure d'architecture de Paris-Belleville / Christophe Cuny, architecte urbaniste

Olivier Boesch, architecte urbaniste / Élodie Bousquet, géographe urbaniste

Regina Abadi, graphiste

Hélène Saudecerre, paysagiste

Léna Soffer, paysagiste - Paysage ETC...

Frédérique de Gravelaine, écrivain, editing

Architectes assistants : Raphaëlle Davin, Alexis Lagarde, Edouard Giafferi, YongHo Moon, Rémy Siméon

SYSTRA BET TRANSPORTS

Hubert Metge, ingénieur spécialiste planification des transports - mobilité durable

ARTE CHARPENTIER ARCHITECTES

Jean-Marie Charpentier, architecte

Lovisa Hagdahl, architecte

**IPRAUS (INSTITUT PARISIEN DE RECHERCHE ARCHITECTURE URBANISTIQUE SOCIÉTÉ)
ÉCOLE NATIONALE SUPÉRIEURE D'ARCHITECTURE DE PARIS-BELLEVILLE (ENSAPB)**

Pierre Clement, architecte, urbaniste, professeur EnsaPB, directeur Ipraus

Sabine Guth, architecte, chercheur, enseignante EnsaPB

Bernadette Laurencin, architecte, chercheur spécialiste SIG, enseignante EnsaPB

Jean-François Coulais, géographe, chercheur

Beatrice Mariolle, architecte, chercheur, enseignante EnsaPB

Assistants chercheurs : Amélie Fontaine, Liu Yang et Ernesto Apolaya-Canales

**CNRS ARCHITECTURE URBANISME SOCIÉTÉS - ÉQUIPE TERRITOIRES
DE LA MONDIALISATION ET VILLES PORTUAIRES**

Michèle Collin, sociologue, chercheur CNRS

Thierry Baudouin, sociologue, chercheur CNRS

BLUE

Jean-Robert Mazaud, architecte - Développement durable : S'PACE Architectes
associés-BLUE HOLDING

Catherine Parant, architecte-ingénieur, spécialiste HQE : BLUE-S'PACE

BLUE-2DKS

Alain Schnaidt, architecte-écologie urbaine

Daniel Kaufman, architecte-écologie urbaine

BLUE-F4CT

Nicolas Houdant, expert énergétique

Sylvestre Coudert, expert forestier

CONSULTANTS

Joan Busquets, architecte, Barcelone - professeur, université d'Harvard, USA

Bruno Fortier, architecte urbaniste - professeur EnsaPB

Jean-Michel Guénod, Archimed consultant en stratégie de développement territorial
& aménagement

Francis Nordemann, architecte urbaniste - professeur, EnsaPB

Simon Ronai, géographe, société Orgeco, conseil en développement territorial

Dani Karavan, sculpteur, Paris - Florence - Tel-Aviv

Henri Gauchotte, Conseil Communication

Frédéric Metzinger, groupe SAPN

Antoine Lefebure Monzague, spécialiste Internet

ÉQUIPE 6

(AJN) JEAN NOUVEL

(AREP) JEAN-MARIE DUTHILLEUL

(ACD) MICHEL CANTAL-DUPART

BIRTHS AND REBIRTHS

OF A THOUSAND AND ONE PARISIAN JOYS

Adding rather than replacing, densifying, building upwards... These are some of the key concepts for this team, which calls for a return to the “the genius loci – the spirit of place”, a notion much maltreated in the last thirty years. This densified Greater Paris is also infiltrated and reoccupied by biomass, landscape and art.

By taking zoning out of the urban planning process, it develops on the existing fabric under the impetus of local authorities, firms and individuals who are asked to fill the empty spaces, by extending houses upwards, by enlarging existing buildings, and finally by returning to traditional forms. Warehouses are transformed into lofts, offices flow into former residential buildings, parking lots are occupied by civic amenities, large estates are not demolished but enhanced, heightened, embellished...

This city, infiltrated by a meshwork as dense as the Paris Metro, is irrigated by interconnected low-speed and high-speed transport systems. A dozen TGV stations and some fifteen new hubs serve the Châtelet and Gare du Nord nodes. At the “Highpoints” – La Courneuve, Gennevilliers, Velizy-Villacoublay and Choisy-le-Roi – stand vertical eco-estates whose mixed-use towers overtop the current authorised height limits. Finally, in the valleys of the Seine, the Bièvre, the Yvette and the Orge, the riverbanks are available for development, as rivers, roads, forests, and farmland have fringes, “land fronts”, pockets of urbanisation that merge with the landscape.



© ATELIER JEAN NOUVEL

PERSONNALITÉS

Alexandre Allard / Rémy Babinet / Patrick Bouchain / Daniel Buren

Michel Desvigne / Alain Fleischer / Anne Lacaton / Jean-Philippe Vassal

CONSULTANTS

Hervé Bagot / Guy Burgel / Patrice Goulet / Serge Martin

Raphael Menard (Elioth) / Bertrand Nouvel

ATELIERS JEAN NOUVEL

Didier Brault, David Fagart, Toshi Kubota, Fabrice Lextrait, Philippe Papy,
Jean-Paul Robert

Responsables de thèmes

Isabelle Agostini, Arnaud Brichet, Alain Gwozdenovic, François Leininger,
Jean-Jacques Raynaud, Nathalie Sassow

Architectes

Anne-Sophie Bernard, Fanny Besse, Gilberto Bonelli, Agnese Canziani,
Aurélien Coulanges, Khadija Djellouli, Elen Le Dez, Sylvain Menaud,
Clément Meurice, Thomas Moreau, Marie-Charlotte Prosper, Nabila Zerouki

Graphisme

Nathalie Saccu de Franchi, Marie Maillard, Rafaëlle Ishkinazi, Eugénie Robert,
Vatsana Takham, Elise Taponier

3D

Raphael Renard, Benjamin Alcover, Mizuho Kishi, Sébastien Rageul

Paysage

Xavier Haegeli, Ewen Le Rouic, Alice Mahin

Communication

Charlotte Kruk, Charlotte Huisman

Stagiaires

David Bertal, Nathan Brami, Thérèse Egnor, Park Minkiong, Veronica Olariu,
Thibault Ricci, Jack Self, Fabien Thuile, Shih-Hao Tseng

Photographies

Benoît Fougeirol, Pierre Nouvel, Maris Mezulis, Valère Terrier

Textes

Édouard Dor

Dessins

Didier Ghislain

AREP

Catherine Gatineau, Louis Moutard, Étienne Tricaud

Équipe

Nicolas Augris, Julien Cataldo, Laure Cochet, Maxime Genevri, Cécile Lesueur

Graphisme

Vincent Donnot

ATELIER CANTAL-DUPART

Bozena Kluba, Christine Larousse, Lea Znaty
Sibylle Rerolle, François Cuvelier

PARTICIPATION AUX ATELIERS DE RECHERCHE

Polau (Pôle des arts urbains)/Maud Le Floc'h, Polau/Hélène Delpeyroux, Polau/
Géraldine Tronca, Agence Sherpaa/Luc Gwiazdzinski, Sherpaa/Gilles Rabin
Ensci (École nationale supérieure de création industrielle)/Alain Cadix, Ensci/
Christophe Gaubert, Ensci/Bruno Angella, Fing (Fondation Internet nouvelle
génération)/Jacques-François Marchandise, Fing/Thierry Marcou, Fing/Daniel Kaplan
AYK/Yann Kersalé, AMD/Martin Basdevant, Anabelle Boucher, Sylvie Cadot, Cnam/
Claude Cohen, Cnam/Sébastien Dauge, Jérôme Deschamps, Patrick Doutreligne,
Gaël de La Porte du Theil, Cnam/Brice Duthion, Gérard Feldzer, Robert Fullilove,
Thompson Mindy Fullilove, Jean-Claude Giblin, Cnam/Michel Godet, Véronique Heon
Klin, Cnam/Michel Herrou, Bachir Kerroumi, Olivier Le Roux, Cnam/Jacques Lebas,
Jacques Roger-Machart, Cnam/Gilles Rousseau, Cnam/Maxime Schirrer, Jean-Marie
Stephan, Georges Vauzeilles, Cnam/Jean-Claude Ziv

ÉQUIPE 7

STUDIO 09 _ BERNARDO SECCHI E PAOLA VIGANÒ THE POROUS CITY

Porosity: relation of the empty to the full, of the unbuilt to the built, of vegetable to mineral, of accessible space to uncoupled space. This quality defines the Paris metropolis as imagined by Studio 09: porosity through a remodelling of the landscape, porosity through a multiplied transportation system, porosity to create a habitat revised and corrected for “sustainability”.

Replacing a capital riven with fractures that separate individuals at all scales, the porous city re-establishes connections, facilitates communication, mixes populations. Landscape creates links. Wetlands upstream of the Seine restore Île-de-France’s characteristic biodiversity, allow the development of local river transport, reinforce the relationship between the different habitats, generate new leisure areas.

The goal of the porous city is absolute accessibility. Everyone can travel to any point in the metropolis via a dense network of green routes and public transport services: metro lines, regional railway lines and trams form a series of 2.5 km wide lattices. The city itself is integrated into a Europe-wide communication network, through a high-speed train that runs across it. The porous city adapts its fabric to the challenges of energy. The vacant interstices in residential neighbourhoods provide a reserve of land for the development of renewable energy use within the existing housing pool.

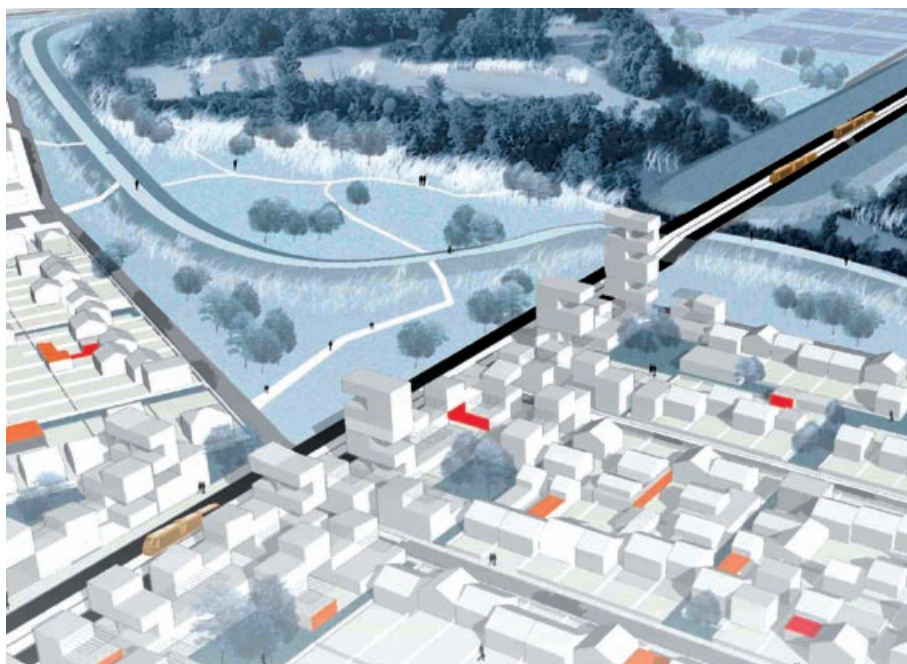

© ÉQUIPE STUDIO 09, SECCHI-VIGANÒ

STUDIO 09

Bernardo Secchi e Paola Viganò

Alessia Calò, Dao Ming Chang, Teresa Cos, Nicolas Fonty, Alvise Pagnacco

IUAV - ISTITUTO UNIVERSITARIO DI ARCHITETTURA DI VENEZIA

DOCTORAT EN URBANISME

Lorenzo Fabian, Emanuel Giannotti, Paola Pellegrini

PTV FRANCE (BUREAU D'ÉTUDES MOBILITÉ)

Frédéric Reutenauer, Florence Prybyla, Matthias Lenz

INGENIEURBÜRO HAUSLADEN GMBH

Gerhard Hausladen, Josef Bauer, Jacobsen Cornelia, Cécile Bonnet, Robert Fröhler

MIT AND P-REX

Alan Berger

CLEMSON AND P-REX

Case Brown

MOX

Alfio Quarteroni, Piercesare Secchi

Carlo D'Angelo, Fabio Nobile, Fabio Della Rossa

EMU EUROPEAN MASTER IN URBANISM

Michael Hadjistyllis

Birgit Hausleitner

Tiffany Fleur Ellen Hodgson

Kuanchung Huang

Samira Khorram Shahy

Hamed Khosravi Al Hosseini

Takumi Kimura

Eleni Anna Kotsikou

Dong Won Lim

Ana Alejandra Rafful Hernandez

Kaveh Rashidzadeh

Makarand Salunke

Ivan Dario Solano Doncel

Karen Patricia Spezini Stanley

Evelyn van Houtte

Bruna Vendemmia

Wim Wambecq

Alexander Wandl

Qinyi Zhang

PHOTOGRAPHIES

Teresa Cos

MONTAGE DES VIDÉOS DES IMAGINAIRES

Thomas Hachette

COLLABORATION À LA RÉALISATION DES VIDÉOS ET DES MAQUETTES

Paola Andreoli, Fatima Bianchi, Giuseppe Dizonno,

Roberto Rezzoli, Laura Stroszeck

Le travail de l'équipe Studio 09 Bernardo Secchi e Paola Viganò a bénéficié des conférences aimablement données par Frédéric Gilli, Michel Meybeck, Guy Burgel, Mathieu Flonneau, Marie-Hélène Massot, Christian Mosey et Evelyne Cohen lors du workshop «Paris ville poreuse» organisé par le EMU, avec le soutien du ministère de la Culture et avec l'aide de James Njoo.

ÉQUIPE 8

LIN FINN GEIPEL + GIULIA ANDI

CENTRES OF INTENSITY, LIGHT CITY AND WIDE LANDSCAPES

The defining feature of this team is its lightness of touch. Declining to force outcomes, it initiates a local dynamic then allows events to develop spontaneously to create a metropolis with flexible and multifunctional spaces. Its “Greater Paris” has two overlapping forms of urban fabric. Firstly, densely constructed “centres of intensity” create new focal points that become metropolitan-scale landmarks.

They are linked by a system of fast, reserved-track buses connected to the existing rail network, with travel speeds of almost 40 km/h on average, as compared with 15 km/h for existing inner-city public transport systems. Secondly, the loose fabric that stretches around the intensity centres to form a “light city” is not densely built but structured.

There is room here for micro-centres and micro-mobility to form a continuous network of services, shops and a transport system that is quasi-private, yet integrated into the global public transport system. In this light city, the different kinds of landscape – woodland, farmland, meadowland or urban wasteland – perform multiple roles: recreational space, food and energy production, air and water purification, a refuge for biodiversity and a climate regulator... The river network becomes the focal system for these poetic and technological transformations: behind the reeds, submerged turbines produce energy.



© ÉQUIPE LIN

ARCHITECTURE URBANISME

LIN Finn Geipel + Giulia Andi, Berlin Paris

Finn Geipel, Giulia Andi, Ali Saad, CdP
Heiko Walth, CdP, Andrea Alessio, Marie-Elsa Batteux
Nathanaëlle Baës-Cantillon, Agnès Billemont
Laura Delaney, John Klepel
Jan-Oliver Kunze, Florian Mathon
Elena Pavlidou-Reisig, Judith Stichtenoth

SOCIÉTÉ

Joseph Hanimann, Paris

STRATÉGIE URBAINE

Wilhelm Klauser, Berlin

THÉORIE DE L'ARCHITECTURE ET DE L'URBANISME

Kaye Geipel, Berlin

PHILOSOPHIE

Liliana Albertazzi + François Jullien, Paris

ÉCOLOGIE URBAINE

Universität Oldenburg - Michael Kleyer, Oldenburg

MOBILITE

Systematica, Milan Cagliari

Fabio Casiroli / Francesco Sechi

INFORMATION DESIGN

Institute for Information

Design Japan, Tokyo

Andreas Schneider / Itoko Ishihara

HISTOIRE DE L'URBANISME

Technische Universität Berlin, unité histoire de la ville

Johannes Cramer

VILLE ET DEVELOPPEMENT DURABLE

Harvard University Graduate School of Design

Mathias Schuler

DESIGN LABORATORY

Massachusetts Institute of Technology, Boston

MIT School of Architecture + Planning

William Mitchell / Federico Casalegno / Ryan Chin

REPRÉSENTATION DE LA VILLE

Integral Ruedi Baur, Zurich Paris Berlin

Ruedi Baur / Sébastien Thierry / Alexander Stephenson

ÉDITION

Jean-Michel Place, Paris

Technische Universität Berlin, unité histoire de l'art

Bénédicte Savoy

GRANDE PERSPECTIVE

Davide Abbonacci, Berlin

MASSACHUSETTS INSTITUTE OF TECHNOLOGY, BOSTON

MIT Design Studio / Finn Geipel / Mark Watabe / Lara Davis

Najiyah Edun / Rafael Luna / Joe Michael / Michelle Petersen

John Pugh / Alice Rosenberg / Laura Rushfeldt

TECHNISCHE UNIVERSITÄT BERLIN

LIA Master class / Finn Geipel / Vesta Nele Zareh

Richard Woditsch / Giulia Beretta / Yoann Fiévet

Sönke Hartmann / Iris Lacourde / David Malaud / Tristan Zelic

ÉQUIPE 9

ATELIER CASTRO DENISSOF CASI

LE GRAND PARIS DU DEVOIR D'URBANITÉ

Un futur grand Paris «solidaire et poétique», car «nul n'habite un schéma directeur»... Cette «utopie concrète» s'inscrit dans le réel et dans l'urgence. Le territoire retenu de 40 km² se partage en une fédération de huit sous-ensembles définis par les limites naturelles de la topologie et du paysage. Il est ponctué de monuments symboliques, des «cartes postales» comme «l'Agora du grand Paris» à la confluence de la Seine et de la Marne, ou la «Foire du monde multipolaire» à Gonesse, ou encore «Toutes les Mémoires au Mont Valérien», qui font naître fierté et appropriation des lieux chez leurs habitants. Politique car il déconcentre les bâtiments des grands services publics et les disperse sur le territoire urbain, ce projet prône l'efficacité opérationnelle grâce à de nouveaux processus de décision et le rapprochement d'acteurs essentiels mais trop souvent concurrents comme la RATP et la SNCF.

Une seule entité développerait plus rapidement les nouvelles lignes de transport en commun : trois tramways périphériques, un métro express sur le tracé de l'A 86 et des Batobus sur la Seine et la Marne. En rendant accessibles – avec un ticket de métro unique – les lieux enclavés ou excentrés, ce maillage favorise l'intensité urbaine et la mobilité géographique et professionnelle. Les quartiers d'habitat social sont remodelés et embellis, les zones d'emplois densifiées par une nouvelle mixité de fonctions.



© ÉQUIPE ATELIER CASTRO DENISSOF CASI

ATELIER CASTRO DENISSOF CASI

Roland Castro, architecte urbaniste
Sophie Denissof, architecte urbaniste
Silvia Casi, architecte urbaniste

LABORATOIRE ARCHITECTURE, MILIEUX, PAYSAGES DE L'ÉCOLE NATIONALE SUPÉRIEURE D'ARCHITECTURE DE PARIS-LA VILLETTE (ENSAPLV)

Jean-Pierre Le Dantec, directeur

NEXITY - VILLES ET PROJETS

Jean-Luc Poidevin, président-directeur général

BERIM, BUREAU D'ÉTUDES TECHNIQUES

Michel Bleier, président

RÉFÉRENT DE L'ÉQUIPE

Laetitia Vidal, chargée de communication, Atelier Castro Denissof Casi

Pierre Allal, architecte, Atelier Castro Denissof Casi

Cyril Aouizerate, promoteur d'idées

Pascal Aubry, paysagiste, laboratoire de recherche Architecture, milieux, paysages, EnsaPLV

Yann Aubry, directeur du développement, Nexity-Apollonia

Augustin Berque, géographe, directeur d'études à l'EHESS

Étienne Bitauld, architecte, Atelier Castro Denissof Casi

Hélène Bleskine, écrivain

Jordi Borja, directeur du programme Gestion de la ville à l'Université ouverte de Catalogne

Alain Bourdin, directeur de l'Institut français d'urbanisme

Laurent Castellani, président de Keops

Éric Charmes, maître de conférences à l'Institut français d'urbanisme

Gwenaëlle Chorin, architecte-perspectiviste, Atelier Castro Denissof Casi

Jean-Paul Dollé, agrégé de philosophie et sociologue

Céline Do Nascimento, attachée de direction, Atelier Castro Denissof Casi

Alain Freytet, paysagiste, École nationale supérieure du paysage de Versailles

Sihem Habchi, présidente de « Ni putes ni soumises »

Laurent Habib, président d'Euro RSCG C&O

Vincent Heuzé, directeur général de Nexity Villes et Projets

Guillaume Idier, directeur de la communication de Nexity

Hervé Jezequel, photographe, enseignant à l'EnsaPLV

Jean Kieffer, gérant de Habania, conseil en aménagement et immobilier

Arnaud Laffage, plasticien et paysagiste, EnsaPLV

Hervé Le Bras, directeur du laboratoire de démographie historique (CNRS-EHESS) et directeur d'études à l'EHESS

Frédéric Léonhardt, urbaniste, chargé de mission territoriale à l'Agence nationale pour la rénovation urbaine (Anru)

Samir Mihi, président de « Au-delà des mots »

Anne Mollet, directeur marketing stratégique de Nexity

Olivier Mongin, directeur de la revue Esprit

Jérôme Monnet, directeur adjoint de l'Institut français d'urbanisme

Lucie Munsch, directeur associé Euro RSCG C&O

Gilles Olive, ingénieur et consultant dans les domaines du bâtiment et des territoires

Jean-Luc Orand, responsable du service aménagement urbain de Berim

Anne Philippe, cinéaste, EnsaPLV

Carine Robert, directeur du développement, Nexity Villes et Projets

Robert Rochefort, directeur du Centre de recherche pour l'étude et l'observation des conditions de vie (Credoc)

Alain Roy, directeur général adjoint de Keops

Guy Sorman, économiste, essayiste et éditeur

Catherine Tournoux, fondatrice de Mandragore, atelier d'études paysagères

Serge Trigano, ancien président du Club Méditerranée, fondateur de Town & Shelter

ÉQUIPE 10
MVRDV AVEC ACS + AAF
PARIS MORE small [CAPA-CITY]

Does post-Kyoto inevitably mean less for the cities? Paradoxically, for MVRDV, the future solution lies in MORE: more optimistic, more ecological, more intense, more efficient and more... small. Turning their backs firmly on urban sprawl, characterised as Parisian “ugliness”, the team proposes to increase the density of Greater Paris sufficiently to shrink it to an area 30 km square.

This strategy is based on a tool, the “city-calculator”, which compares the performances of the world’s big cities. The total score (economics, pollution, accessibility, unemployment, quality of life, energy production, etc.) of the Paris metropolis could be improved by concentrating its qualities within a more compact area. The approach is to continue the much appreciated Haussmannian fabric by recreating large north-south and east-west axes to the periphery, while finishing the roofing of the Périphérique and building new overhead metro lines. The demand for housing is met by reoccupying available spaces in existing built-up areas, by increasing density in detached housing districts and by adding one or two storeys to apartment buildings.

Greater Paris achieves energy autonomy by exploiting the flow of the Seine, covering roofs with photovoltaic panels and creating a new landscape of wind turbines on the outskirts of the city. The conversion to a sustainable city also entails reforestation of the land, in particular the environmentally poor areas around Roissy airport.

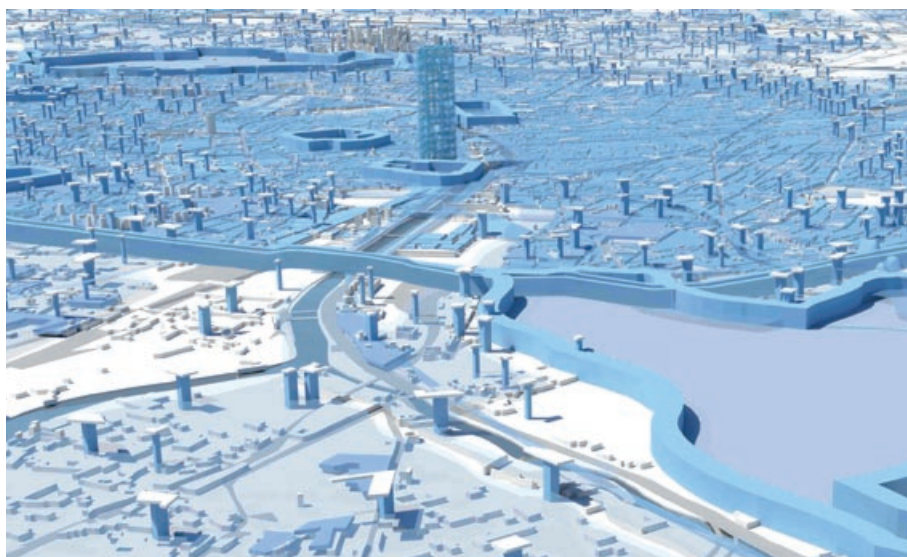

© MVRDV

MANDATAIRE COMMUN

MVRDV, Winy MAAS

MVRDV

RECHERCHE, DESIGN, ÉDITION

Winy Maas, directeur, architecte urbaniste

Jacob Van Rijs, directeur, architecte

Nathalie De Vries, directeur, architecte

Jeroen Zuidgeest, architecte

Bertrand Schippan, architecte maître d'œuvre

Sabina Favaro, architecte

Flore Raimbault, architecte

Sonia Assouly, architecte

Martine Vledder, urbaniste

Di Miao, architecte

Manuel Galipeau, architecte

THE WHY FACTORY, TU DELFT

Winy Maas, professeur, architecte urbaniste

Ulf Hackauf, architecte, chercheur associé

Why Factory

AAF

Andrei Feraru, architecte, maître assistant

associé à l'École nationale supérieure d'architecture Paris-Malaquais

Romain Boursier, architecte

ACS - ÉCOLE NATIONALE SUPÉRIEURE D'ARCHITECTURE PARIS-MALAQUAIS (ENSAPM)

Monique Eleb, professeur, directrice du laboratoire Architecture, culture et société

XIX^e-XX^e siècles CNRS, psychologue, docteur en sociologie, professeur à l'EnsaPM

Andrei Feraru, architecte, maître assistant associé à l'EnsaPM

Sabri Bendimerad, architecte dplg, urbaniste, maître assistant associé à l'EnsaPM

Philippe Simon, architecte dplg, urbaniste DEA, maître assistant associé à l'EnsaPM

Patrick Celeste, architecte urbaniste

Clément Orillard, architecte dplg

CHERCHEURS INDÉPENDANTS

Dominique Lefrançois, docteur en urbanisme, chercheur associé au laboratoire

Le Lab'Urba, Institut d'urbanisme de Paris, université de Paris XII Val-de-Marne

Michèle Attar, géographe, DEA, AMO, membre du Conseil économique et social, directeur général de la SA de HLM « Toit et joie »

Françoise Cremel, paysagiste, enseignante, paysage et territoire

Jean Leonard & Martine Weissmann, architectes urbanistes, écologie, durabilité

AEU (Atelier d'écologie urbaine), Jean-Louis Ducreux, docteur géologue, écologie, pollutions, mutations géo

Franck Boutte consultant, Franck Boutte, haute qualité environnementale (HQE)

VISUALISATION

Eline Wieland & Marino Gouwens

Wieland&Gouwens, Animation

Avec MVRDV

DESIGN GRAPHIQUE

Paul Ouwerkerk, Graphic Language

Avec MVRDV

AN JOURNEY-BASED EXHIBITION

The scenography of the exhibition, designed by the architect Jean-Christophe Quinton, winner of the Nouveaux albums des jeunes architectes award 2004, adapts itself perfectly to the highly specific content of the museum's Galerie des moulages, the largest space in the Cité de l'architecture & du patrimoine.

It presents ten contemporary installations in a historical itinerary, giving each team the freedom to make the most of their space to present their proposal. This approach gives rise to ten different ways of presenting ten research and development strategies.



© J-C QUINTON

THE EXHIBITION

The « Le Grand Pari(s) » Exhibition presents the results of the international consultation «Le Grand Pari de l'agglomération parisienne », commissioned by the government with the support of the Ministry of Culture and Communication. The exhibition is designed and created by the Cité de l'architecture & du patrimoine / Institut français d'architecture, with the support of the musée des Monuments français.

François de Mazières, president of the Cité de l'architecture & du patrimoine
Francis Rambert, director of the Institut français d'architecture
Hervé Lemoine, director of the musée des Monuments français

Production and overall coordination

Myriam Feuchot, pôle production manager, Ifa
Christine Carboni, project manager, Ifa
Martine Colombet, chief editor, Ifa

Scenography

Jean-Christophe Quinton
With: Benoît Dumont, Guillaume Ramillien, Laurence Cheret
Alma Gazeau and Morgan Henry, Susie Kim, interns

Design of module interior

Each of the ten teams had total free reign to design how they would represent their project in their allocated space.

Exhibition artwork

Dorothée Beauvais

Photographic report Île-de-France

Dominique Delaunay, Ifa

Text

Frédéric Mialet and Catherine Sabbah
For the Scientific Council: Paul Chemetov, Michel Lussault
Historic introduction: Pierre Pinon
French/English translations: John Crisp, Eileen Powis

Architect interviews

Francis Rambert
Direction: Stéphane Demoustier,
Production année zéro, www.annee0.com
© Cité de l'architecture & du patrimoine, 2009

Multimedia

Luc Lièvre, financial director, information systems director,
Cité de l'architecture & du patrimoine
Installation: Soft audiovisuel
Advised by: Artistic vidéo
Coordination and settings: Jérôme Richard, Michel Pinto, DSI Cité
For the historic introduction (« Paris, des enceintes aux schémas directeurs »)
Scientific coordination: Pierre Pinon, architect, historian
Direction and iconographic research: Cité de l'architecture & du patrimoine /
musée des Monuments français,
Corinne Bélier, museum curator; Aude Mathé, audiovisual and photographic project
manager; Marielle Blanc, iconographer
Artwork: Laurent Simonini, Pleine Lune

Registrar

Jonathan Deledicq, Ifa
Alain Vandest, Cité
Nicolas Chesnais & Rachid Ouai

Musée des Monuments français Registrar

Hélène Perrel, registrar
Denis Bouvier, assistant registrar

Exhibition setup

Nicolas Barthelemy, Nicolas Boulard, Jérôme Galos, Dominique Junca, Christian Loca

Creation of stage design equipment

Charpente Cénomane (wooden frame)
Pyrrhus conceptions (outer façades)
Créations du Val d'Oise (printing on Dibond® and creation of introductive modules)
En Apparence (digital reprography)
Exprimm (electricity)

Communication

Jean-Marie Guinebert, director of communication and partnerships,
Cité de l'architecture & du patrimoine
Guillaume Lebigre
Claire Le Roy, graphic designers, Cité
Agostina Pinon, media relations, Cité, in coordination with Valérie Samuel
and Arnaud Pain, Opus 64

Publication

Special edition AMC/Le Moniteur
"Le Grand Pari(s)"
256 pages, €29

The exhibition enjoyed the partnership of the RATP and the SAEM Val de Seine, as well as the support of IGN and iGuzzini, Point P., Samsung, ThyssenKrupp Cadillac Plastic et Alcan composites, Tollens, Utram.

Media Partners

Les Échos
Evene.fr
L'Express
France 2
France 3 Paris Île-de-France Centre
France Info
Groupe Moniteur
LCP Assemblée Nationale
Métro

A mobile systematic version of this exhibition is scheduled for Autumn 2009, with the support of the Region.

AROUND THE EXHIBITION AT THE CITÉ DE L'ARCHITECTURE & DU PATRIMOINE

PUBLICATION

«Le Grand Pari(s)», AMC/Le Moniteur special issue
254 pages, 29 €

THE «GREAT PARIS RENDEZ-VOUS»

The exhibition organised by the Cité will be illustrated throughout by conferences featuring architects who participated in the consultation.

The Pompidou centre will organise a conference in autumn 2009 that will bring together important witnesses and architects to discuss the city's critical issues in direct connection with the productions of the ten teams.

For their part, some of the «écoles nationales supérieures d'architecture» will organise, up until 2010, a series of conferences on the large regional cities of the 21st century.

AUDIOVISUAL PROGRAM SCHEDULE

Bringing together documentaries and feature films, this monthly schedule – that forms part of the «Architecture series» cycle – extends the theme of «Le Grand Pari(s)» exhibition.

Saturday 30th May

2.30pm: *Conversation between Paul Chemetov & Paul Delouvrier*

Documentary by Alain Esmerly. France, 1990. «Parisian past» collection.

Production by the Paris audiovisual centre / Image Forum. Colour video projection.

Running time: 56 mins

3.30pm: *Special conditions of Parisian traffic*

Anonymous documentary, France, 1929. 35mm black and white, silent, tinted.

Lobster films collection. Running time: 10 mins

4pm: *Grandeur and brevity of La Défense*

Documentary by Frédéric Biamonti. Colour video projection. France, 2008.

Production by Antoine Martine Production and France 3 Paris Ile-de-France.

Running time: 52 mins. Projection in the presence of the director Frédéric Biamonti.

Saturday 27th June

2.30pm: *9/3, Memories of a territory*

Documentary by Yamina Benguigui. Production by Elemiah, with the participation of Canal +. Colour video projection. Running time: 1½ hrs.

4pm: meeting with the director Yamina Benguigui.

Saturday 26th September

2.30pm: *Two or three things I know about her*

Film de Jean-Luc Godard. France, 1967. 35mm, couleur. Durée: 1h23

Film présenté par Dominique Païni

ITINERANT EXHIBITION

An itinerant and simplified version of the exhibition is planned in the Île-de-France in autumn 2009, with the support of the Region.

TO FIND OUT MORE

www.citechaillot.fr / www.legrandparis.culture.gouv.fr

THE CONDUCT AND PROCEDURES OF THE CONSULTATION

Following upon the announcement made on 17 September 2007, the President of the Republic put Madame Christine Albanel, Minister of Culture and Communication, in charge of the organisation and management of the consultation. This consultation was intended, in liaison with the local governments concerned, to develop a “prospective, urban and green space diagnosis on Greater Paris with a twenty, thirty or even forty-year outlook”.

The Minister of Culture and Communication formed a steering committee comprised of representatives from the State, the city of Paris and the Île-de-France region. In order to ensure the representation of the region’s mayors, the Association of Mayors of Île-de-France (AMIF) was represented in the committee by its president and secretary general, both mayors.

Two major constraints framed the consultation: on one hand, the multidisciplinary teams composed of urban planners, economists, sociologists, landscape designers and so on were to be headed by a commissioned urban planner or architect; on the other, a scientific council was responsible for guaranteeing the quality and complementarity of the ten teams. An operational scientific cell was in charge of handling the coordination and material organisation of the consultation. Each team had a key resource person to answer its various questions. In particular, the scientific cell submitted, at the beginning, a large group of documents and organised special access to the statistical, photographic and geographical statistics required by the teams.

A partnership was formed with the region’s major urban planning agencies (APUR, IAU-RIF...) and public services (RATP, SNCF, Aéroports de Paris, Port autonome de Paris, VNF...). The Ministry of Culture and Communication chose the EMOC (public corporation for the development of cultural works) to launch invitation to tenders for the international consultation, published on 5 March 2008. The EMOC was therefore subsequently the manager of the contract with each team, after each “service provided” phase.

On 21 May 2008, the choice of the teams was made, at the Ministry of Culture and Communication, by the EMOC’s special invitation to tenders commission in which the steering committee members participated. On June 4, 2008, the teams’ commissioners were received by the President of the Republic. They were then brought together by the Minister of Culture and Communication who thus launched the first research phase.

The first step of the process was marked by the first scientific coordination seminar, on 13 October 2008, during which a discussion took place between the teams, the steering committee and the scientific council. During the second seminar, organised in workshops, on 11 December 2008, the teams presented the final results on “the 21st-century post-Kyoto metropolis” as well as the intermediate results of the project on “the diagnostic forecast for the Paris conurbation”. At the third scientific coordination seminar, on 12 March 2009, the final results of the second project were discussed.

At each stage, the teams had to submit a 120 to 150-page book in colour as well as a “spatial representation system” showing the principal analyses in three dimensions. After each submission, the Ministry of Culture and Communication organised meetings between the steering committee and the scientific council so that the latter could report its observations to the steering committee and a dialogue between the two structures could be established.

All the teams’ productions will be published in two boxed sets corresponding to the two projects, during the first half of 2009. After the debates organised by the Cité de l’architecture & du patrimoine from May to November 2009, a colloquium prepared by the Centre Georges Pompidou will present the historical and theoretical keys to the development of the metropolis to the general public. Moreover, at the end of 2009 and in 2010, based on the work carried out, the national architecture schools will organise research and development work on the major regional metropolises of the 21st century, in collaboration with the local governments concerned.

Jean Gautier

Director for architecture

Architecture and Heritage Department

Ministry of Culture and Communication

CONSULTATION CALENDER

5TH MARCH 2008

Call for tender for the consultation issued

15TH APRIL 2008

Deadline (12:00pm) for return of application and tenders for the consultation

28th April 2008

First meeting of the tender commission (selection of applications)

21ST MAY 2008

Second meeting of the tender commission (selection of tenders)

4TH JUNE 2008

Signature of the contract by the procuring body and notification

5TH JUNE 2008

Inaugural session with the teams selected and beginning of the first research phase

15TH SEPTEMBER 2008

Meeting of the steering committee

Installation of the scientific council

Meeting of the scientific council and teams

6TH OCTOBER 2008

First intermediary submission of works for two research sites

13TH OCTOBER 2008

First seminar of scientific coordination at the Conseil économique et social

14TH OCTOBER 2008

Meeting of scientific coordination at the Ministry for Culture and Communication

Beginning of second phase of research

22ND OCTOBER 2008

Meeting of steering committee at the Ministry for Culture and Communication

24TH OCTOBER 2008

Meeting of teams and territorial authorities at the Cité des sciences
et de l'industrie

19TH NOVEMBER 2008

Work session bringing together teams and transport/infrastructure operators

4TH DECEMBER 2008

Definitive submission of works on "the 21st century post Kyoto metropolis"

Intermediary submissions on "the prospective diagnosis of the Paris conurbation"

11TH DECEMBER 2008

2nd seminar of scientific coordination with workshops at the Université Paris 8

12TH DECEMBER 2008

Meeting of scientific council at the Ministry for Culture and Communication

Beginning of the third phase of research

19TH DECEMBER 2008

Meeting of steering committee at the Ministry for Culture and Communication

16TH JANUARY 2009

Second meeting of teams and territorial authorities at the Centquatre

19TH FEBRUARY 2009

Definitive submissions of works on “the prospective diagnosis of the Paris conurbation”

4TH MARCH 2009

Meeting of steering committee at the Ministry for Culture and Communication

12 MARCH 2009

3rd seminar of scientific coordination at the Conseil économique et social

13TH MARCH 2009

Meeting of scientific council at the Ministry for Culture and Communication

17TH MARCH 2009

Public debate “Le Grand Pari(s) - À la recherche de nouveaux équilibres” organised by the Cité de l’architecture & du patrimoine at the Théâtre national de Chaillot (“Les Rendez-vous du Grand Paris”)

27TH MARCH 2009

Conclusive meeting of the steering committee at the Ministry for Culture and Communication

30TH APRIL TO 22ND NOVEMBER 2009

Exhibition at the Cité de l’architecture & du patrimoine

AUTUMN 2009

Conference at the Centre Pompidou (“Les Rendez-vous du Grand Paris”)

END OF 2009/2010

Conferences on the large regional metropolises of the 21st Century organised by écoles nationales supérieures d’architecture as part of « Rendez-vous du Grand Paris »

THE CONSULTATION

MINISTRY FOR CULTURE AND COMMUNICATION

Christine Albanel, minister for Culture and Communication

Organisation and observation of consultation

- Michel Clément, director of architecture and heritage
- Jean Gautier, director, architecture manager, assistant to director of architecture and heritage
- Laurence Cassegrain, assistant director for architecture education, training and research, architecture and heritage management
- Eric Lengereau, head of the office of architectural, urban and landscape research, architecture and heritage management

STEERING COMMITTEE

Ministry for Culture and Communication

Michel Clément, director of architecture and heritage

Jean Gautier, director, architecture manager,
assistant to director of architecture and heritage

Ann-José Arlot, general inspector of cultural affairs

Ministry for Ecology, Energy, Sustainable Development and Territorial Planning

Etienne Crépon, director of Habitat, Urban Development and Landscapes

Secretary of State for Development of the Capital Region

Pierre Veltz, director of the capital region mission

Secretary of State for Territorial Planning

Guillaume Sainteny, representative of the Secretary of State for Territorial Planning

Ministry of the Interior, Overseas and Territorial Authorities

Michel Camux, prefect of the Val-de-Marne

Interministerial Delegation for Planning and Territorial Competitiveness

Eliane Dutarte, advisor to the representative, capital region mission

Préfecture of the Île-de-France Region

Pascal Lelarge, préfet, regional director for facilities in Île-de-France

City of Paris

Anne Hidalgo, senior assistant to the Mayor of Paris,
in charge of urban development and architecture

Pierre Mansat, assistant to the Mayor of Paris, in charge of the Metropolis of Paris

Île-de-France Region

Mireille Ferri, vice-president of the Île-de-France Regional Council

Ariane Azéma, technical advisor to the cabinet of the President of the Île-de-France
Region

Association of Mayors of Île-de-France

Claude Pernès, president of AMIF, regional councillor, mayor of Rosny-sous-Bois

Gilles Catoire, secretary general of AMIF, general councillor of Hauts-de-Seine,
Mayor of Clichy-la-Garenne

Associate members

Eric Garandeau, technical advisor for Culture Communication on the presidency
of the Republic

Jean-Claude Dumont, president of the EMOC

François de Mazières, president of the Cité de l'architecture & du patrimoine

CONSEIL SCIENTIFIQUE

Paul Chemetov, co-president of the scientific council, architect and urban planner, awarded the Grand Prix national d'architecture in 1980

Michel Lussault, co-president of the scientific council, geographer, professor of universities at the École normale supérieure de Lyon, manager of the "Espaces et territoires" research programme at the Agence nationale de la recherche

Dominique Alba, architect and urban planner, general director of the Pavillon de l'Arsenal, executive director of the Atelier parisien d'urbanisme

Pascal Amphoux, geographer architect, professor at the école nationale supérieure d'architecture de Nantes, member of the consultation's scientific and technical committee

Patrick Berger, architect and urban planner, professor at the École polytechnique fédérale de Lausanne, awarded the Grand Prix national d'architecture in 2004

Manuel Castells, socio-economist, professor emeritus at the University of Berkeley, director of research at the Internet Disciplinary Institute of Barcelona

Elena Cogato Lanza, architect, professor at the École polytechnique fédérale de Lausanne, member of the consultation's scientific and technical committee

Philippe Estèbe, geographer, director of studies at Acadie coopérative conseil, tutor at the Institut d'études politiques de Paris and at the École nationale des ponts et chaussées

Vincent Fouchier, urban planner, assistant executive director at the Institut d'aménagement et d'urbanisme d'Île-de-France, Île-de-France regional master plan coordination delegate

Massimiliano Fuksas, architect and urban planner, awarded the Grand Prix national d'architecture in 1999

Peter Hall, urban planning professor at the Bartlett School of Architecture and urban planning, University College London, former member of the Urban Task Force to Great Britain's Prime Minister

Sébastien Marot, assistant professor at the école nationale supérieure d'architecture de Marne-la-Vallée, professor invited to chair landscaping at ETH Zurich

Ariella Masbouni, architect and urbaniste en chef de l'État, responsible for the «urban project» at the Ministry of Ecology, Energy, Sustainable Development and Land Use.

Philippe Panerai, architect and urban planner, awarded the Grand Prix de l'urbanisme in 1999

Dominique Perrault, architect and urban planner, awarded the Grand Prix national d'architecture in 1993

Frédéric Pousin, architect, director of research at CNRS, member of the consultation's scientific and technical committee

Francis Rambert, architecture critic, director of the Institut français d'architecture à la Cité de l'architecture & du patrimoine

Bernard Reichen, architect and urban planner, awarded the Grand Prix de l'urbanisme in 2005

Francis Rol-Tanguy, ingénieur général des ponts et chaussées, director of Atelier parisien d'urbanisme

Joseph Rykwert, historian of architecture and urban development, professor emeritus at the University of Pennsylvania

Saskia Sassen, sociologist, professor at the University of Columbia, invited professor emeritus at the London School of Economics

Thomas Sieverts, architect and urban planner, professor emeritus at the Technical University of Darmstadt

Marcel Smets, architect and urban planner, professor at K. U. Leuven University, advisory architect to the Flemish government

Pieter Uyttenhove, architect, professor at the University of Gant, member of the consultation's scientific and technical committee

OPERATIONAL SCIENTIFIC UNIT

Ministry for Culture and Communication

Eric Lengereau, architect, head of the office of architectural, urban and landscape research

Panos Mantziaras, architect, assistant professor at the école nationale supérieure d'architecture de Paris-Malaquais, chargé de mission scientifique at the office of architectural, urban and landscape research

Nicolas Tixier, architect, assistant professor at the école nationale supérieure d'architecture de Grenoble, chargé de mission scientifique at the office of architectural, urban and landscape research

Eric Alonzo, architect, resource centre manager at the école nationale supérieure d'architecture de Marne-la-Vallée, member of Laboratoire infrastructures, architecture, transports (Liat) at the école nationale supérieure d'architecture de Paris-Malaquais

Xavier Dousson, architect, tutor at the école nationale supérieure d'architecture de Paris-Malaquais, member of Architecture Ville Design (AVDa) at Université de Paris 1 Panthéon-Sorbonne

Fanny Lopez, historian, tutor at the école nationale supérieure d'architecture de Paris-Malaquais, member of Laboratoire infrastructures, architecture, transports (Liat) at the école nationale supérieure d'architecture de Paris-Malaquais

James Njoo, architect, assistant professor at the école nationale supérieure d'architecture de Paris-la-Villette, researcher at the University of Zurich

Corinne Tiry, architect, researcher at the Laboratoire d'architecture, conception, territoire, histoire (Lacth) at the école nationale supérieure d'architecture et de paysage de Lille, tutor at the école nationale supérieure d'architecture de Paris-Belleville

Catherine Genouel, budget officer at the office of architectural, urban and landscape research

Edith Fauchaux, incentive policy coordinator within the office of architectural, urban and landscape research

Muriel Souvignon, assistant at the office of architectural, urban and landscape research

COMMUNICATION

Ministry for Culture and Communication

Paul Rechter, advisor in communication for the minister of Culture and Communication, head of the department of information and communication

Anne Petitjean, head of the pôle éditions et publications, department of information and communication

Olivier Bouilland, head of the pôle multimédia, department of information and communication

François Muller, head of the department of communication and documentation, architecture and heritage management

Manuel Candré, assistant to the head of the department of communication and documentation

Christine de Rouville, chargée de mission for media relations, department of communication and documentation

Jutta Nachbauer, chargée de mission for events, department of communication and documentation